



Laborkugelhahn Typ 522 PVC-U Innengewinde-Außengewinde

Ausführung:

- Einseitig lösbar
- Kugeldichtung PTFE

Option:

- Schlauchtülle
- Blindstopfen
- Doppelnippel
- Befestigungsglasche
- Sperr- und Dosiererring

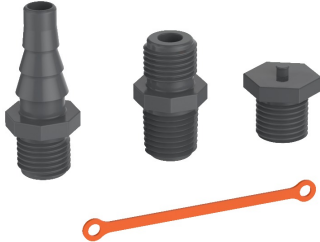

d (mm)	DN (mm)	PN (bar)	EPDM Code	SP	Gewicht (kg)	FKM Code
10	6	10	161 522 060	1	0.050	161 522 070

d (mm)	SP	Gewicht (kg)	G1 (mm)	G2 (mm)	A (mm)	B (mm)	D (mm)	H (mm)	L (mm)	t (mm)	t1 (mm)
10	1	4.8	1/4" BSP	1/4" BSP	26	28.2	28	25.5	56	13.5	12

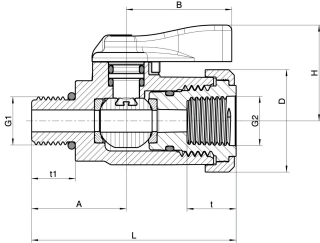

The technical data are not binding. They neither constitute expressly warranted characteristics nor guaranteed properties nor a guaranteed durability. They are subject to modification. Our General Terms of Sale apply.

Georg Fischer Piping Systems Ltd, Postfach, CH-8201 Schaffhausen/Switzerland

Phone +41 -(0)52-631 1111

e-mail: info.ps@georgfischer.com

Internet: <http://www.gfps.com>